

PRESSURE CONTROLLER FOR GAS APPLIANCES

The pressure controller is designed to maintain the input gas pressure to the connected gas appliance at a constant level, in spite of the variable pressure in the supply network and changes in the gas flow. With no consumption (gas flow shut off), the valve of pressure controller will close without any leakage. The device is used primarily for gas-fired kitchen stoves, stoves, radiators and other heating equipment that require constant operating pressure.

The pressure controller is suitable to be used in coal-gas and natural gas supply networks, immediately upstream of the consumer device.



Specification

Type number

5 0 7 5 - 0 - 0 0 1 -

	Measuring unit	1	2	3	4	5	6	0	7
Rated capacity with air (V _n)	m ³ /h	3		4.8		5			3
Capacity range for air	m ³ /h	0.5...3		0.5...4.8		0.5...5			0.5...3
Factory-set output pressure	mbar	8	6	17.5		25	36	22.5	6
Output pressure range (p _k)	mbar	5.5...15		15...25		8...36		5.5...25	5.5...18
Rated internal pressure (p _{bn})	mbar	15		25		85		27.3	15
Input pressure range (p _b)	mbar	8...50		17.5...80		73...100		8...18	8...50
Closing pressure (p _z)	mbar	12	9	26.5		33	33		9
Mounting position (diaphragm plane)		horizontal	vertical	horizontal	vertical	horizontal			

Note: mount the device in horizontal position with the cylindrical extension upwards.

Reference conditions: ambient temperature and gas temperature 20 ± 5 °C, atmospheric pressure 1 + 0.033 bar.

Permissible operating temperature

70 °C max.

Weather resistance class

moderate, indoor

Mass

approx. 0.3 kg

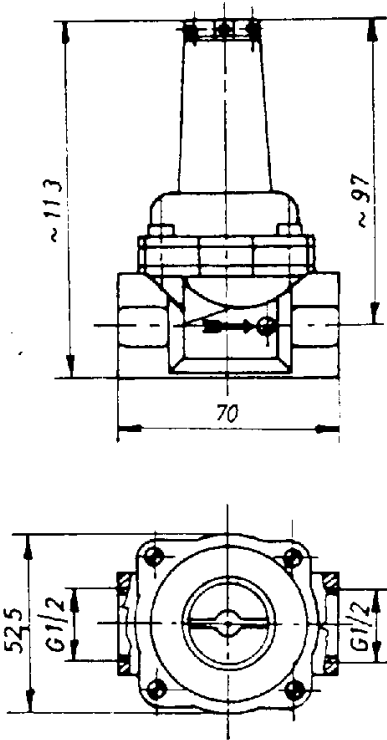

Outline drawing